

SHELTER ASSEMBLY MANUAL

W 14 L 30 H 14 ft

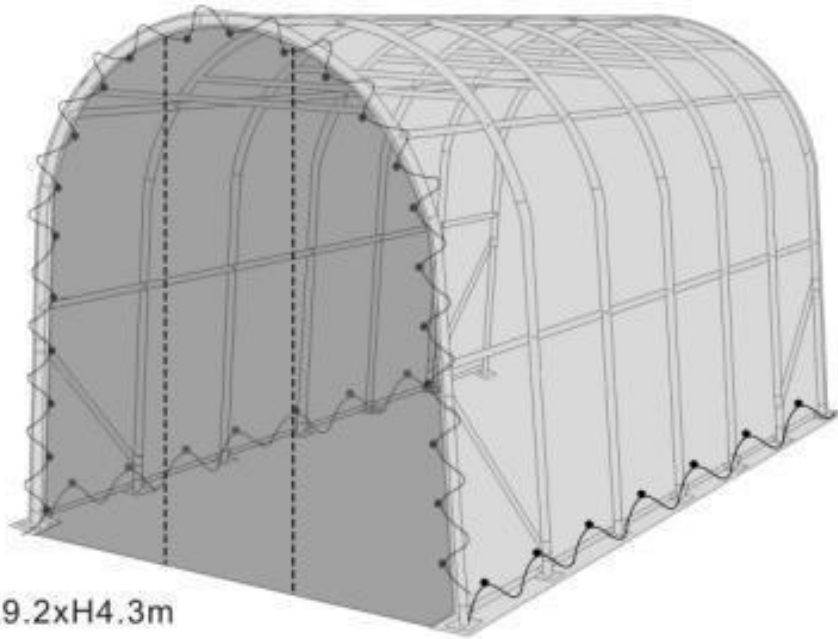

W4.3xL9.2xH4.3m



990 U.S. 27 Venus, FL 33960 United States

sales@storageandcanopy.com

+1 (321) 710-0804

www.storageandcanopy.com

SPECIFICATION

Length: 14 Width: 30 Height: 14 ft

IMPORTANT READ MANUAL FIRST

Improper site preparation, Assembly and Maintenance may invalidate warranty and cause unnecessary and costly mistakes. If you have any questions contact your local dealer.

For User Friendly assembly we have identified each individual component with the part code as indicated in the parts list. Please refer to the part code numbers and drawing to ensure problem free assembly.

It's necessary to tighten the roof fabric enough to avoid "hammocks" on the roof and also re-tighten once or twice again after a few months of use. This is important when assembly in cold weather (autumn and winter) because the fabric is stiff then and when we got the sun and warm weather afterwards it will make the fabric "slack" again and need to be re-tighten before next winter.

It's **the owners responsibility** to take of snow immediately if not slide off by itself.

READ ALL INSTRUCTIONS BEFORE ASSEMBLY

1. Keep work area clean. Cluttered areas invite injuries. Do not set up near snow drifts, in slippery places, in high winds, or wet location.
2. Keep children away. All children should be kept away from the work area.
3. Don't over reach. Keep proper footing and balance at all times.
4. Do not assemble if under the influence of alcohol or drugs. Read warning labels on prescriptions to determine if your judgment or reflexes are impaired while taking drugs. If there is any doubt. Do not assemble.
5. Be aware of possible windy conditions; fasten the bases in concrete if these conditions are likely to occur. Remove the cover during hurricane.
6. Be careful with power and heat sources. Do not keep heat sources near the tarpaulin. Do not expose to open flame.
7. Be aware of personal safety during assembly and use. Be careful not to pinch fingers with clips and tubes when assembling: when using makes sure there is adequate ventilation for exhaust and other dangerous fumes.

Parts List

Part No.	Description	Quantity(pc)
1	Top bent tube	7
2	Top bent tube	7
3	Upright	14
4	Purlin	30
5	Support tube	4
5A	Clip for support tube	8
6	Base plate for four corner(with tie down ratchet on)	4
7	Base plate for inner sidewall upright(with tie down ratchet on)	10
8	Lower tensioning tube	2groups
10A	Horizontal tube	7
13	Stake peg	28
16	Pull zipper door rod	1
17	Roof cover	1
18	Front cover	1
19	Back cover	1
20	Bolt M8x70	77
21	Rope	1
23A	Bolt M10x30	14
24A	Plastic cap	4

26	Narrow Nylon band	14
27	1.5 Tie down ratchet	14

EQUIPMENT AND TOOLS FOR INSTALLATION

- | | |
|-------------------|----------------------------|
| 1. Measuring Tape | 2. String for alignment |
| 3. Stake | 4. Ladder or Scissors Lift |
| 5. Sledge Hammer | 6. Drill |
| 7. Wrench | 8. Knife |

INSTALLATION PROCESS

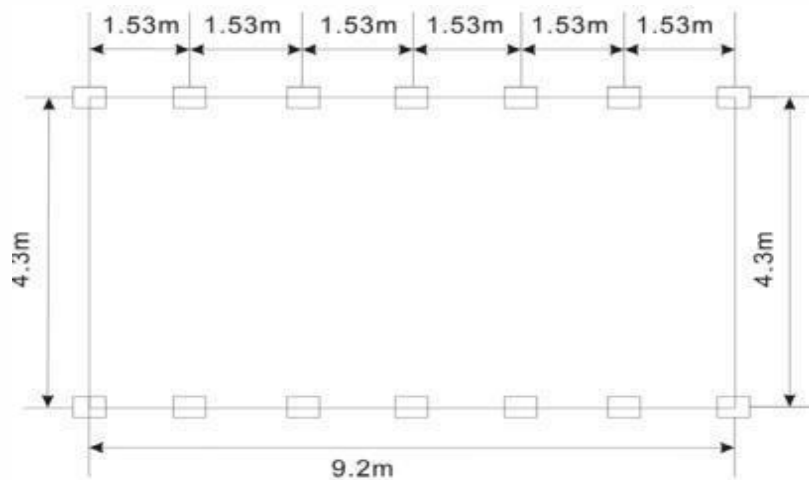
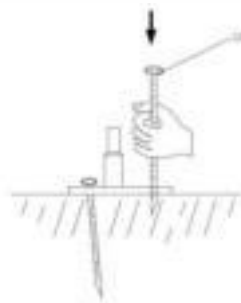

Figure 1

A--- BASE INSTALLATION

Please refer to the diagram (Figure 1) to place the base plates:

1. The measurement is from center to center of tubes on the base plates. Please note it's different of the base plates on the 4 corners and inside. ENSURE THE FOUNDATION IS SQUARES.



Foundation placement

Figure 2

As below shows each Base plate is equipped with 2 pieces of Stake pegs. (No.13)

Method of Placing Stake Peg

1.

Mark the stake peg hold through the base plate by using the stake peg. Move the base plates away and the mark determines where the stake peg will be.

2. **Note:** The stake peg apply for normal conditions, not suitable to the rock ground, frozen soil and concrete ground.

B---FRAME INSTALLATION

1. Please refer to Figure 3 for frame assembly, find one piece of top bent tube(No. 1), one piece of top bent tube(No. 2) and two pieces of Upright(No.3) and assemble every group arch with Bolt M8x70 (No.20) .There are seven groups of arch. Assemble each group arch by turns.

2. Lift another assembled arch into the base plates and connect the assembled two arches by purlins (No.4). The purlins are connected by M8x70 (No.20), there are 4pcs of purlins between each section.

3. By this way, install another arch and then connect them by purlins. There are seven arches and four groups of purlins. You may refer to Figures 3 to find where the parts are when you are doing this.

Note: The support tube (No.5) must be installed by Bolt M8x70(No.20) with clip (No.5A) before installing the arches.

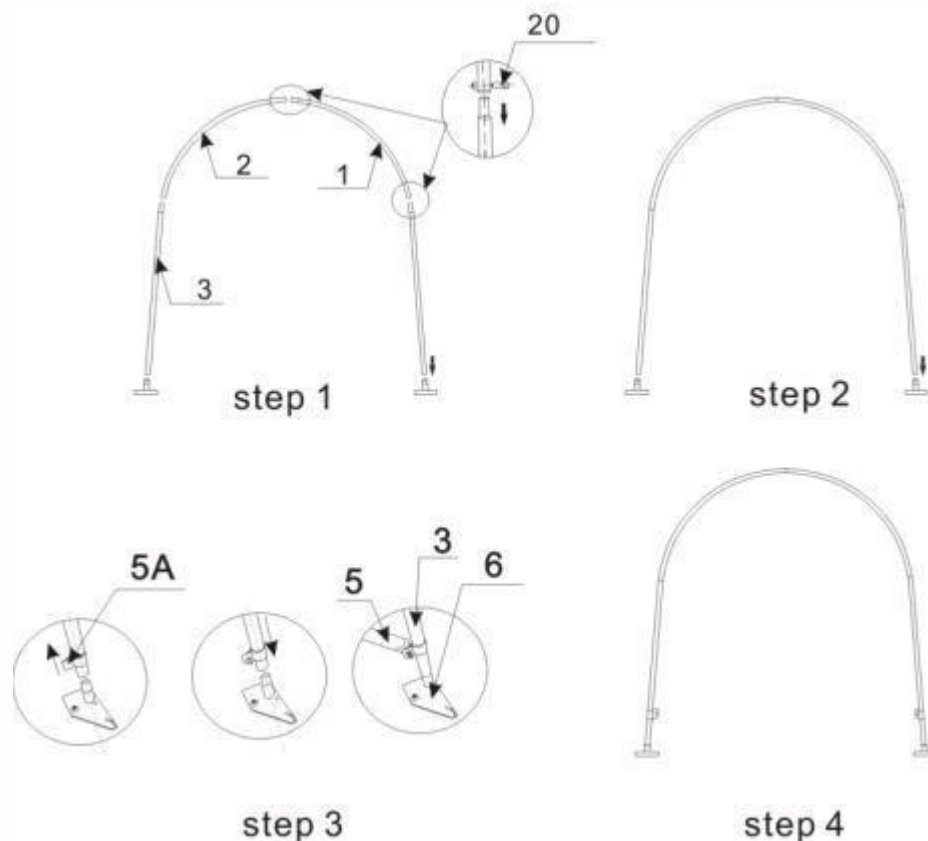
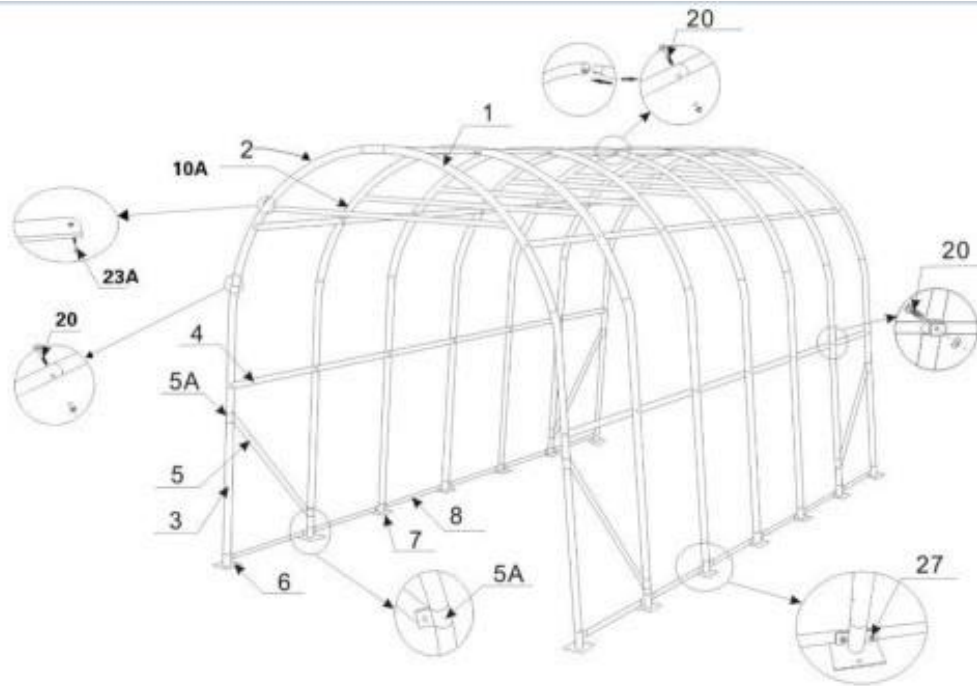

Figure 3



**Figure 4 W4.3
xL9.2 x H4.3m**

C--- INSTALLING THE FRONTAND BACK COVER

Assemble the front and back cover (No.18, 19) by Rope (No.21).

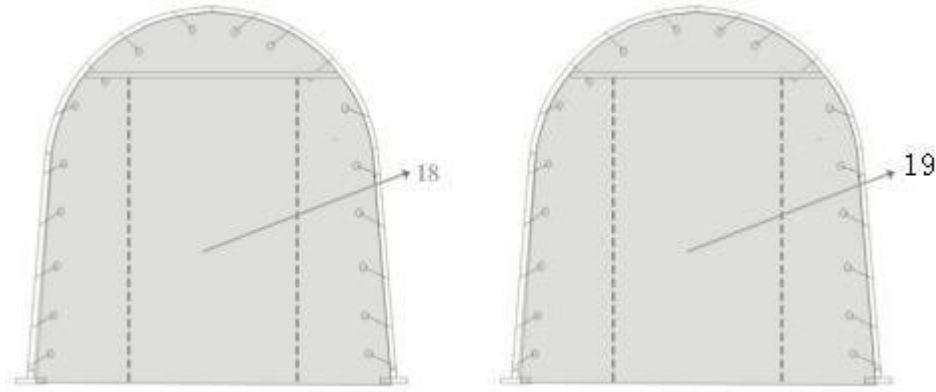

Figure 5 D--- INSTALLING THE ROOF COVER

NOTE: Do not install the cover onto the frame of your building in high wind conditions. A slight breeze is the most advantageous for cover installation. To take advantage of the breeze, pull the cover up over the arches with the breeze blowing in the cover like a sail filled with air.

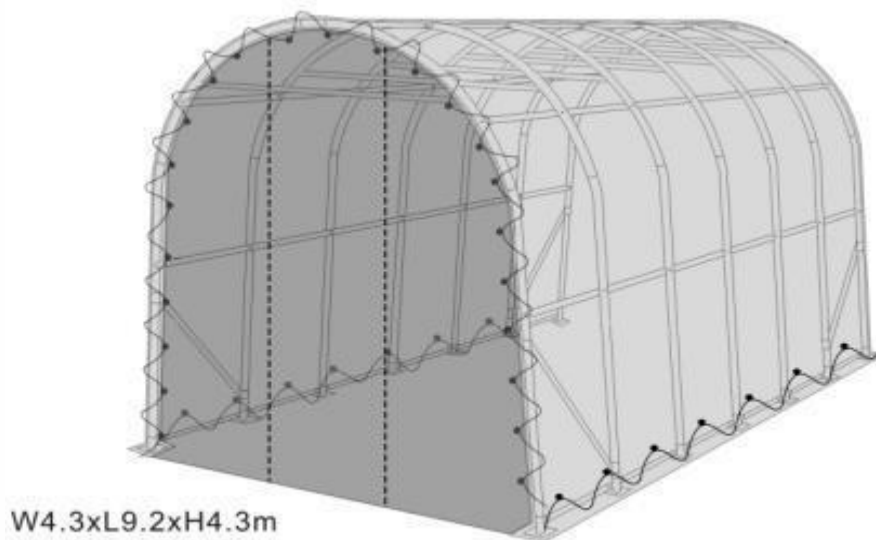

Figure 6

1. Assemble Tensioning Tube for Roof Cover (No.8) before installing the cover.
2. Roll out the roof cover(No. 17) on a ground sheet. Align the cover evenly to each end of the frame. The notices in the roof cover line up with the tie-down-ratchet on the base plates.

Note: Be sure doing not pull over the end of the roof cover.

3. Pull the cover over the frame **EVENLY, CAREFULLY AND SLOWLY**. Insert the tensioning tubes (No.8) into the cover pipe pockets and loosely secure the Nylon Band



990 U.S. 27 Venus, FL 33960 United States

sales@storageandcanopy.com

+1 (321) 710-0804

www.storageandcanopy.com

(No.26) in the Tie Down Ratchet(No.27). Put the plastic cap (No.24A)at the end of tensioning tube.DO NOT TIGHTEN. Adjust the cover so that it is square and evenly centered on the frame. Put the lower tensioning tube inside.

CONGRATULATIONS: NOW YOUR ASSEMBLY IS COMPLETED.