

SHELTER ASSEMBLY MANUAL

40x20x11 ST Container shelter

Single truss



PARTS LIST

Part Code	Description	Qty
1	Roof bent tube	4
2	Upper bent tube	8
3	Shoulder bent tube	8
4	Purlin	21
5	Bottom tensioning tube	0
6L	Left base plate	4
6R	Right base plate	4
7	Iron angle seat	8
8	Bolt M12x30	24
9	Ratchet	8
10	Angle seats	4
11	Ratchet strap	8
12	Bolt M12x110	28
13	Rope	1
14	Self-tapping screw	48
15	ϕ 32 Plastic plug for end of tensioning tube	4
16	Roof cover	1
17	Diagonal tube	16
18	Clip	32



SPECIFICATIONS

Width: 40 ft Length: 20 ft Height: 11 ft

IMPORTANT: READ MANUAL FIRST

Improper site preparation, assembly and maintenance may invalidate warranty and cause unnecessary and costly mistakes. If you have any questions, contact your local dealer.

For an easy assembly process, we have identified each individual component with the part code as indicated in the parts list. Please refer to the part code numbers and drawing to ensure problem-free assembly.

It is necessary to tighten the roof fabric enough to avoid “hammocks” on the roof; also re-tighten once or twice again after a few months of use. This is important when assembled during cold seasons (autumn and winter) because the fabric gets stiff in these weather conditions. When the weather conditions become warmer, the fabric loosens and needs to be re-tighten

It is the owner’s responsibility to take off snow immediately, otherwise it will slide off on its own.

READ ALL INSTRUCTIONS BEFORE ASSEMBLY

1. Keep the work area clean. Accidents are more likely in cluttered areas. Do not set up near snow drifts, in slippery places, in high winds, or wet locations.
2. All children should be kept away from the work area.
3. Don’t overreach. Always keep proper footing and balance.
4. Do not assemble under the influence of alcohol or drugs. Read warning labels on medication prescriptions to determine if your judgment or reflexes are impaired while taking them. If there is any doubt, do not assemble.
5. Be aware of possible windy conditions; fasten the bases in concrete if these conditions are likely to occur. Remove the cover during hurricanes.
6. Be careful with power and heat sources. Do not keep heat sources near the tarpaulin. Do not expose to open flame.
7. Be aware of personal safety during assembly and use. Be careful not to pinch your fingers with clips and tubes when assembling: When using, make sure there is adequate ventilation for any dangerous fumes.

EQUIPMENT AND TOOLS FOR INSTALLATION

1. Measuring tape
2. Alignment string
3. Step ladder
4. Welder
5. Sledgehammer
6. Wrench
7. Scissors

INSTALLATION PROCESS

A - BASE PLATES INSTALLATION

Please refer to the Figure 1 to place the base plates.

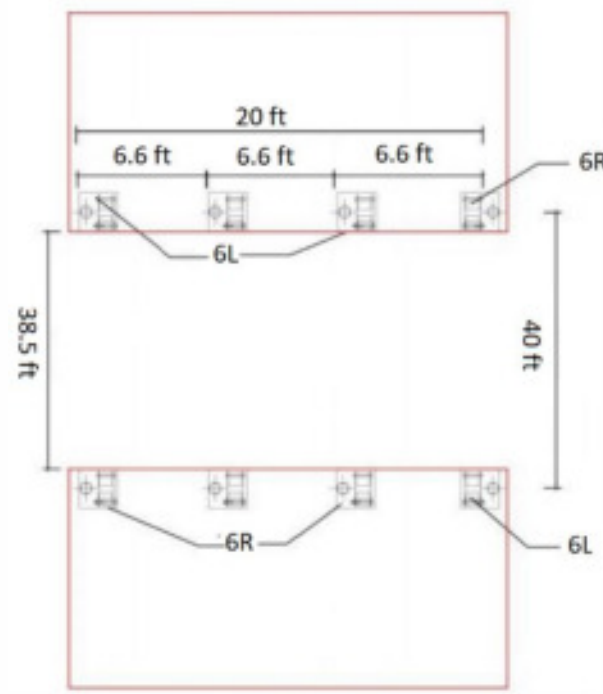

Figure 1

1. The measure must be taken from center to center of the base plates. Refer to the diagram above and confirm the place of the base plates. ENSURE THAT THE FOUNDATIONS ARE SQUARE.
2. All the base plates need to be welded on the Containers.

B - FRAME INSTALLATION (Refer to figure 2 for the full diagram)

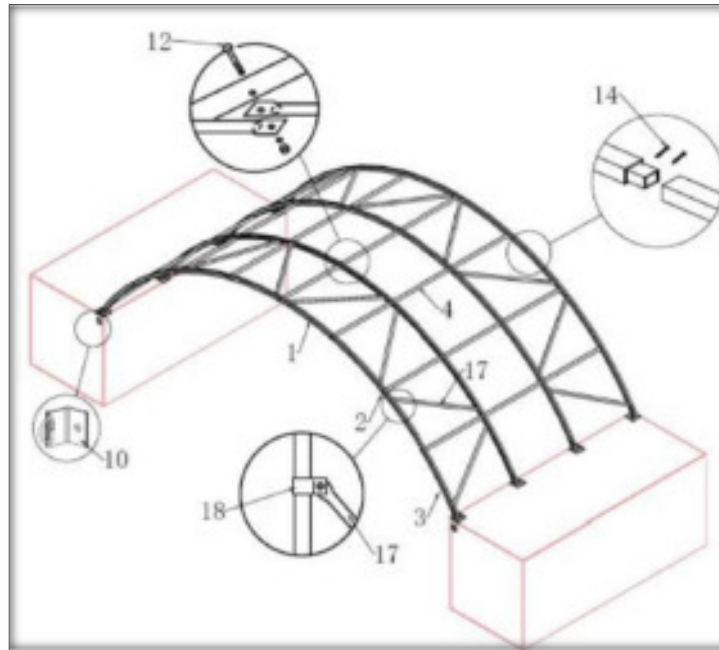

Figure 2

1. Connect the Roof Bent Tube (part code 1), the Upper Bent Tube (part code 2) and the Shoulder Bent Tube (part code 3) with the Self-tapping screw (part code 14); these make one group of arches. Please NOTE the direction of the bolt. **DO NOT** install the bolts on the top of the truss where the fabric will rest.
2. Insert one end of the assembled arch into one base plate and insert the other end of the arch into the opposite base plate. Secure the arches to the baseplates using the bolts.

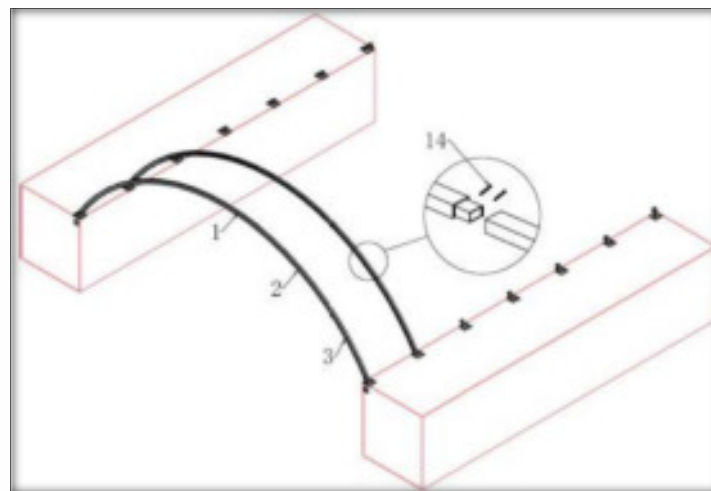

Figure 3

3. After installing the first two arches, connect the Purlin (part code 4) onto them using the Bolt M12x110 (part code 12). There are 7 pieces of Purlins (part code 4) between each arch.
4. Install the Diagonal tube (part code 17) using the Clip (part code 18).

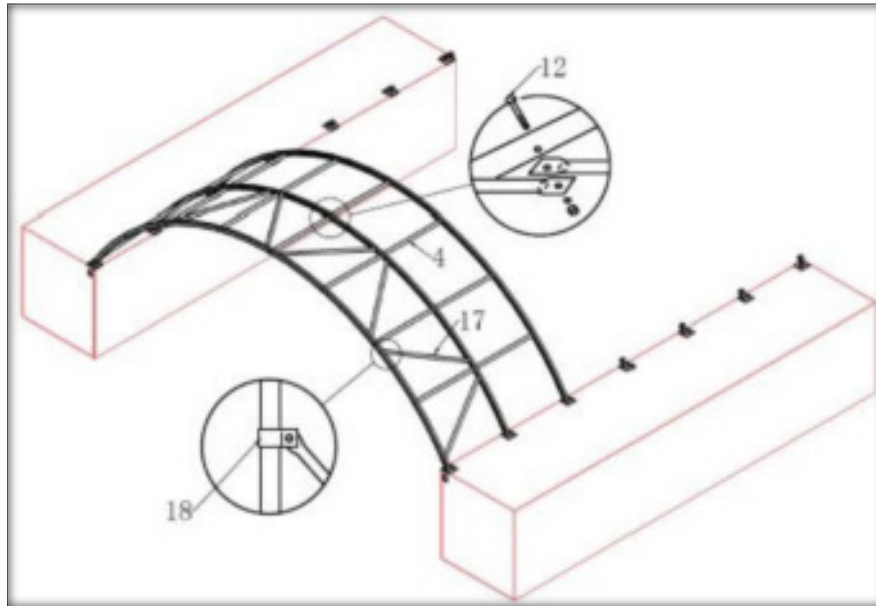

Figure 4

5. Then install the third arch into the base plate and connect the purlins.
6. Assemble the arches one by one until the frame is finished.

C - ROOF COVER INSTALLATION

NOTE: DO NOT install the cover onto the frame of your building in high wind conditions. A slight breeze is the most advantageous for cover installation. To take advantage of the breeze, pull the cover up over the arches with the breeze blowing in the cover like a sail filled with air.

1. Insert the Bottom tensioning tube (part code 5) into the pockets on the end of the roof cover (part code 16). Then put the ϕ32 Plastic plug for end of tensioning tube (part code 15).

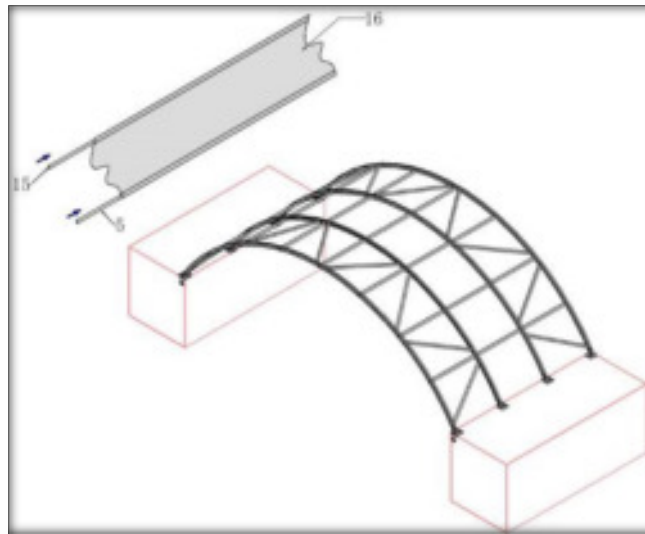

Figure 5

2. Put the Roof cover (part code 16) EVENLY, CAREFULLY AND SLOWLY atop the frame. Adjust the cover so that it is square and evenly centered on the frame.

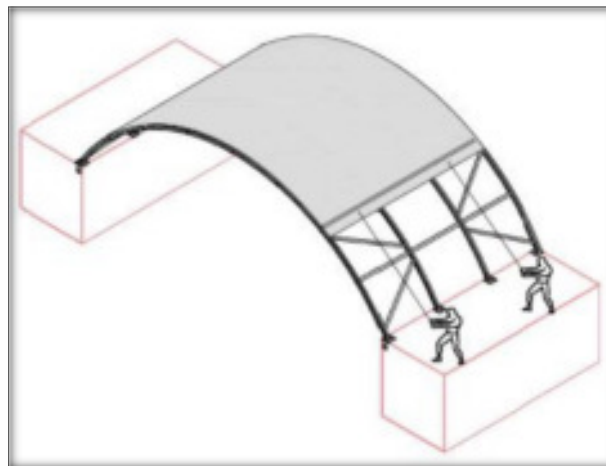

Figure 6

3. On the Roof cover, cut pockets over each ratchet on the base plates, then use the Ratchet strap (part code 11) to tie down the Bottom tensioning tube (part code 5).

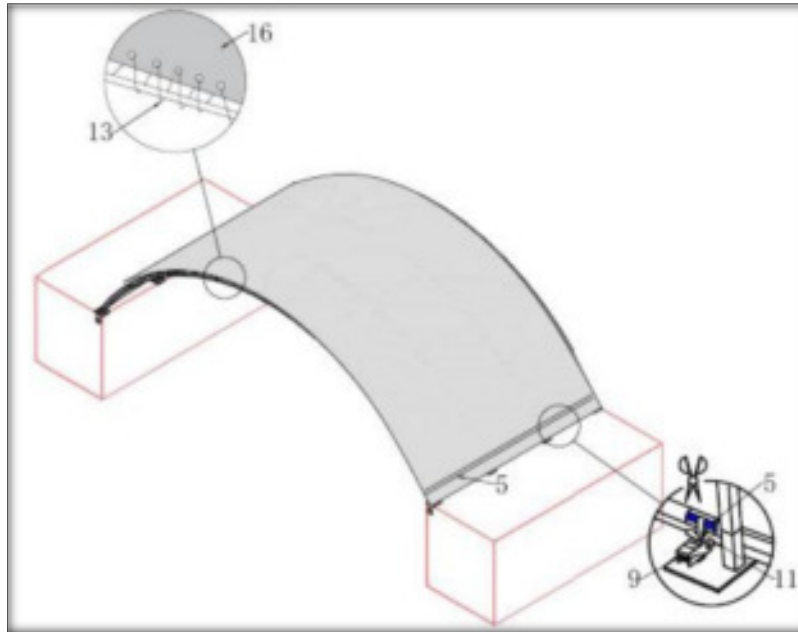

Figure 7

4. Weld the Angle seats (part code 12) on each container and use the Rope (part code 14) to knit the cover on the two side arches. Then tie the Rope to the Angle seats.

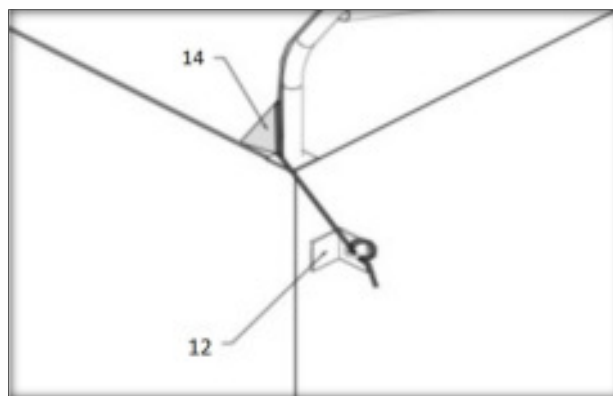

Figure 8

Please, check our installation images and videos section by clicking the following link:

https://drive.google.com/drive/u/3/folders/1p9FLejo-JlrkJPx5_Kp-hDcssOph2dWa



NOTES:

- DO NOT LEAVE THE ROOF COVER UNATTACHED UNDER ANYCIRCUMSTANCES until the final assembly and tightening has been completed.
- The process is quite easy, but some tightening adjustments will be necessary to get a flat, tensioned roof cover. Please adjust the roof cover every month.
- Wrap tape around the gap between the steel after installing.

